

RAZE

RZPT PUSH TROLLEY



RZPT

PUSH TROLLEY

Product Introduction

A plain trolley rated for both manual or powered hoists, with the versatility to fit most types of beams and compatibility to all hoist brands.

- The 5:1 design factor allows the PT Series to be used with both manual or powered hoists. Meets pertinent U.S. (ASME/ANSI and CMAA), Canadian and European standards.
- The side plates, including the rail sweeps/drop stops, are made of cold formed steel for strength, durability and even load distribution.
- The wheel axles are 'rivet-locked' in place so they will not come loose. They are NOT knurled, welded, or modified bolts.
- The wheels are cast iron. The 'universal' tread fits either flat or tapered beams.
- Wheels run on sealed, 'lubed-for-life' ball bearings. Smoother rolling with less effort and...less maintenance.
- Wide hanger shaft assemblies allow the PT Series trolley to fit almost any I-Beam, H-Beam or patented track beam up to 8.06 inch width.

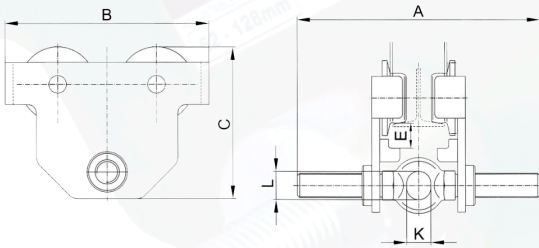

MODEL	RATED CAPACITY	TEST LOAD	MIN. RADIUS OF CURVE	DIMENSIONS (IN)								ADJ. BEAM WIDTH		NETWEIGHT (KG)	
				A PYLON	A LEN. PYLON	B	C	E	F	K	L	M PYLON	M LEN. PYLON	PYLON	LEN. PYLON
RZPT-05	1/2	0.25	0.9	292	377	225	173	33	~3	25	30	50-220	160-305	8.2	8.6
RZPT-1	1	12.5	1	300	385	252	188	31	~3	30	35	58-220	160-305	10.3	10.8
RZPT-2	2	25	1.2	310	395	300	226	32	~3	40	47	66-220	160-305	17.5	18.3
RZPT-3	3	37.5	1.3	324	409	360	289	46	~3	48	58	74-220	160-305	30.7	31.9
RZPT-5	5	62.5	1.4	329	414	392	313	47	~3	60	70	90-220	160-305	42.4	43.9